

PDH2610-Series

Inductance Range: 1.0μH~22μH
Temperature Range: -40℃~+125℃

DIMENSIONS(mm)

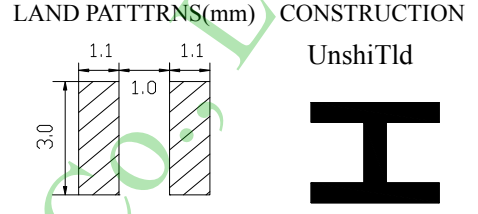
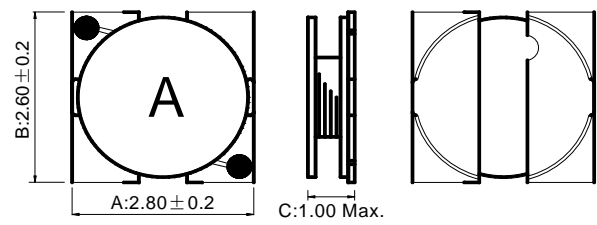

FEATURES:

- ★Quantity / Reel: 6000pcs
- ★Small products, Quadrate 2.8mm*3.0mm Max, Height 0.95mm Type.
- ★The use of carrier tape package for SMT reflow soldering process
- ★Widely use in DC-DC converter/LCD TV/Notebook/PDA/MP3 & MP4 player/Digital camera/DVD etc.
- ★Design to customer requirement

RoHS Compliant(SGS Certified Result)				
Pb	Cd	Cr+6	PBBs	PBDEs
<1000ppm	ND	ND	ND	ND

Electrical Characteristics:

Part Number	Test Condition	Inductance (μH)	Tolerance (%)	D.C.R(mΩ) Max.	Isat1(A) @L-Drop10% (Max.)	Isat2(A) @L-Drop35% (Max.)	I rms(A) @ΔT=40℃ (Max.)
PDH2610-1R0M	100KHz/0.1V	1.0	±20	110	1.40	2.00	1.60
PDH2610-2R2M	100KHz/0.1V	2.2	±20	215	1.00	1.37	1.12
PDH2610-3R3M	100KHz/0.1V	3.3	±20	263	0.85	1.16	1.00
PDH2610-4R7M	100KHz/0.1V	4.7	±20	338	0.70	1.00	0.89
PDH2610-6R8M	100KHz/0.1V	6.8	±20	544	0.61	0.85	0.73
PDH2610-100M	100KHz/0.1V	10	±20	800	0.45	0.60	0.56
PDH2610-150M	100KHz/0.1V	15	±20	1028	0.40	0.55	0.50
PDH2610-220M	100KHz/0.1V	22	±20	1813	0.33	0.45	0.39

- 1、 Inductance is measured with a LCR meter:HP4284A & 3532-50 or equivalent.
- 2、 D.C .R is measured with a Digital Multimeter TH2512B or equivalent.
- 3、 The Isat1 is the current at which the inductance decreases by 10% from the initial value
- 4、 The Isat2 is the current at which the inductance decreases by 35% from the initial value
- 5、 The Irms by Stand-Type is the current at which the temperature rise is ΔT≤40℃, whichever (Ta=20℃)